

Norry Grays Land

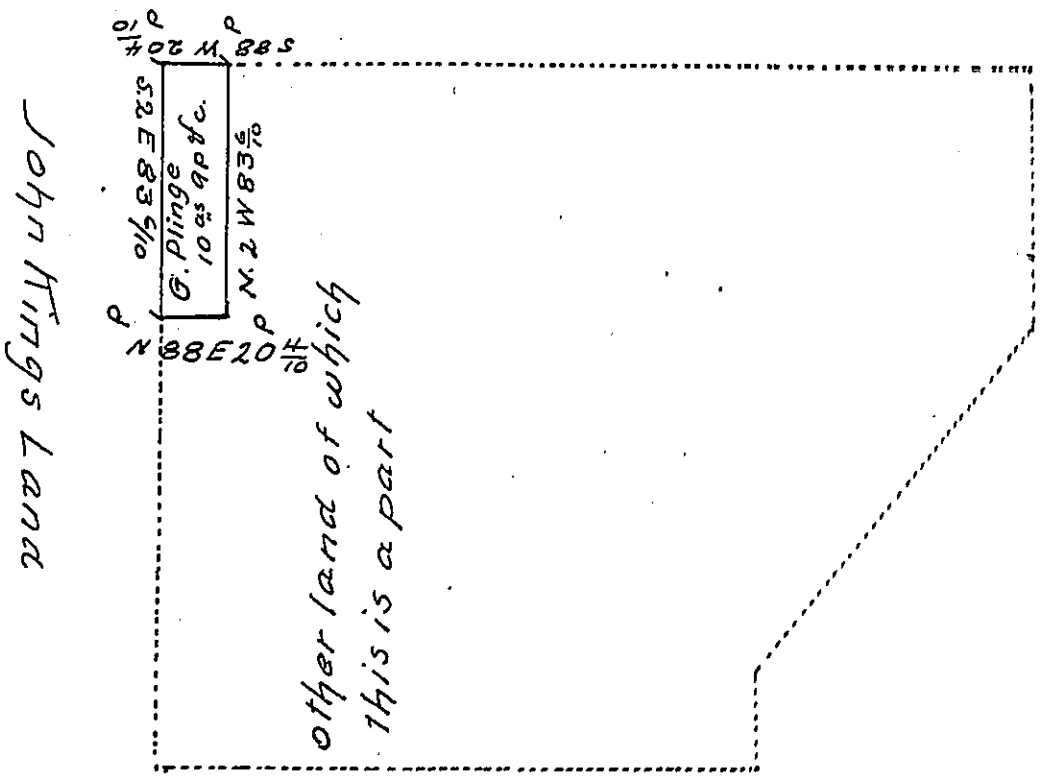

A Draught of a part - a tract of land Surveyed for George Plinge, In pursuance of an order of Survey No 2653 containing ten acres and nine perches with an allowance of six p cent, Situate in Allegheny Township in the County of Westmoreland Surveyed June 7th 1823

Isaac Moore D.S.

Samuel Cochran Esquire

Survc. Genl of Penna

IN TESTIMONY that the above is a copy of the original remaining on file in the Department of Internal Affairs of Pennsylvania, made conformably to an Act of Assembly approved the 15th day of February, 1833, I have hereunto set my Hand and caused the Seal of said Department to be affixed at Harrisburg, this twenty ninth day of July 1905

Samuel P. Rowan
Secretary of Internal Affairs.